

POST FLASHING

DETAIL 15

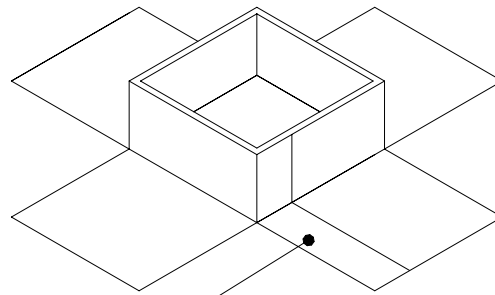

32mm (1 1/2")
OVERLAP AND
CAULK

ASSEMBLY

FACE NAIL (A MIN. OF
TWO NAILS PER SIDE)
AT THE FLASHING ON
EACH SIDE OF POST

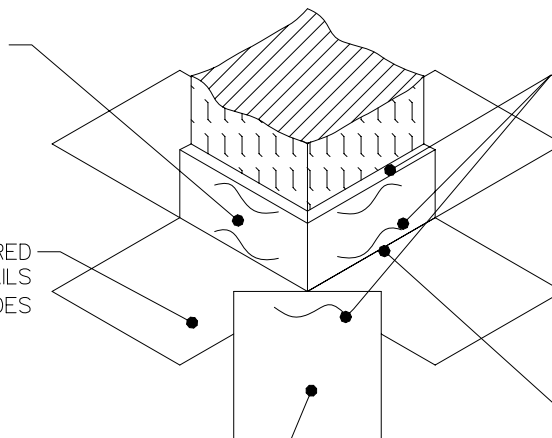

APPLY MANUFACTURER
RECOMMENDED JOINT SEALANT
BEHIND FLASHING AND
AT THE TOP OF THE
FLASHING.

FLASHING IS SECURED
TO SUBFLOOR WITH NAILS
ON ALL SIDES

**APPLY MANUFACTURER
RECOMMENDED JOINT SEALANT
AFTER COMPLETION OF THE
VERSA-DECK SYSTEM AROUND
BASE OF POST. VERSA-DECK
SYSTEM TERMINATES AT THIS POINT**

GALVANIZED, 26 GAUGE, FLAT METAL
INSTALLED ON ALL CORNERS OF THE
POST AND NAILED TO THE SUBSTRATE